



Knob Noster R-VIII School District

401 E. Wimer, Knob Noster, MO 65336
Office: (660) 563-3186 Fax: (660) 563-3026
Student Services: (660) 563-5597

Dr. Jerrod Wheeler, Superintendent of Schools

Mr. Michael Cohron, Assistant Superintendent of Schools

Dr. Angela Rolofson, Director, Student Services

Our Mission Is Student Success

Date: March 30, 2020

To: Knob Noster Public Schools Community

From: Jeff Davis, Director of Technology

RE: Covid-19 Update (14) – How to Change to a Private Network

KN Parents/Guardians,

When you are at home, student computers should be set to private network. This setting can cause many connection issues to various websites. Attached is a pdf file that steps you through setting your laptop/computer to be on a private network.

Sincerely,

Jeff Davis, Director of Technology

Knob Noster Public Schools

1. Click on the Start Button



2. Click Setting Icon



3. Click Network & Internet

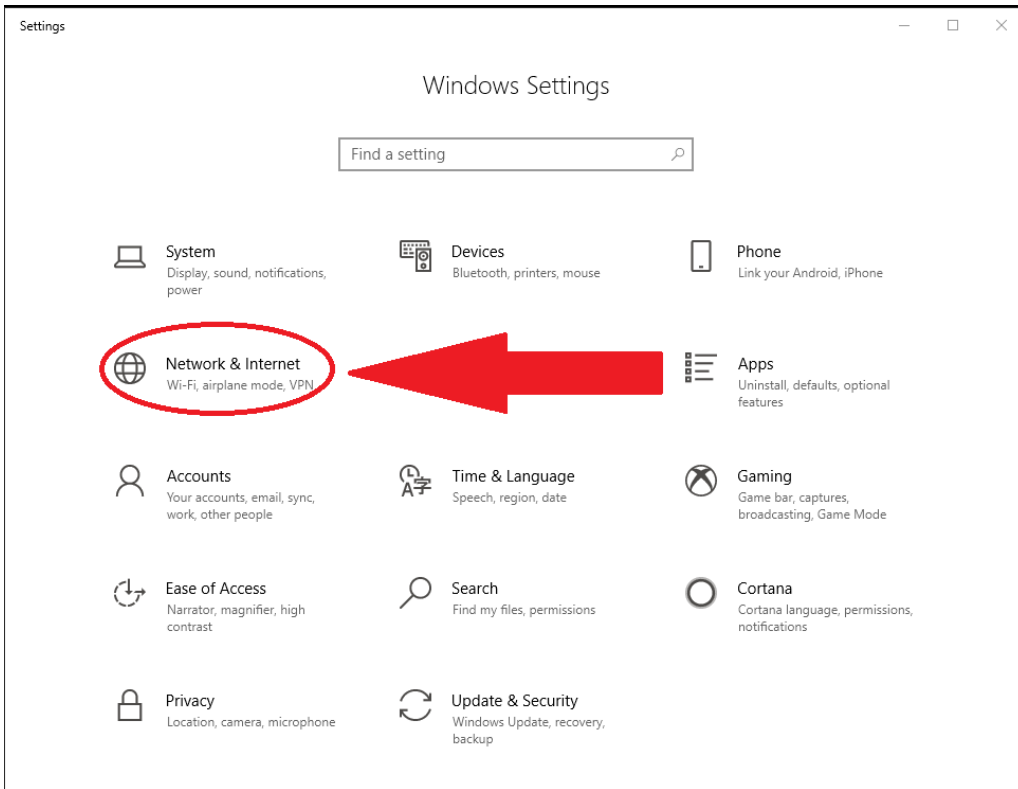

4. If you are on Wi-Fi Click it, if you are plugged in click Ethernet.

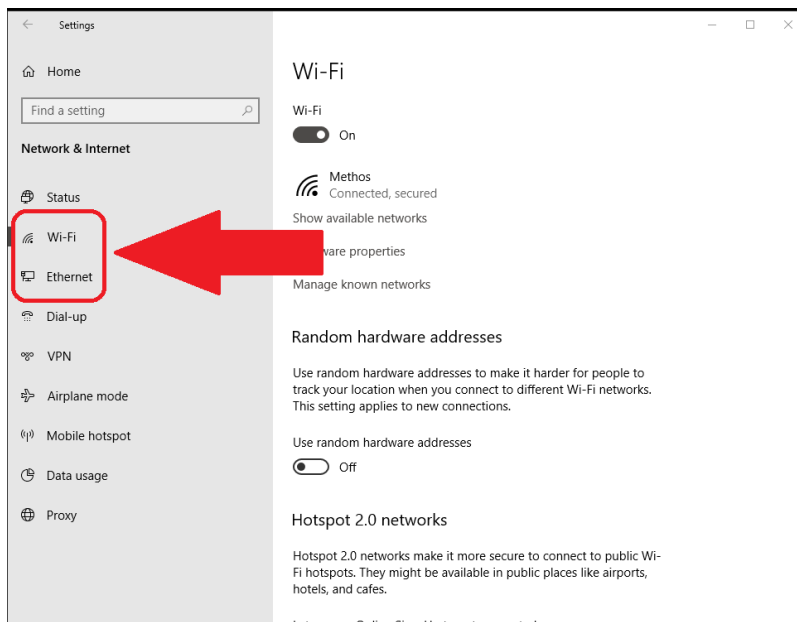

5. If you are on Wi-Fi, click the name of your connection and then click Private.

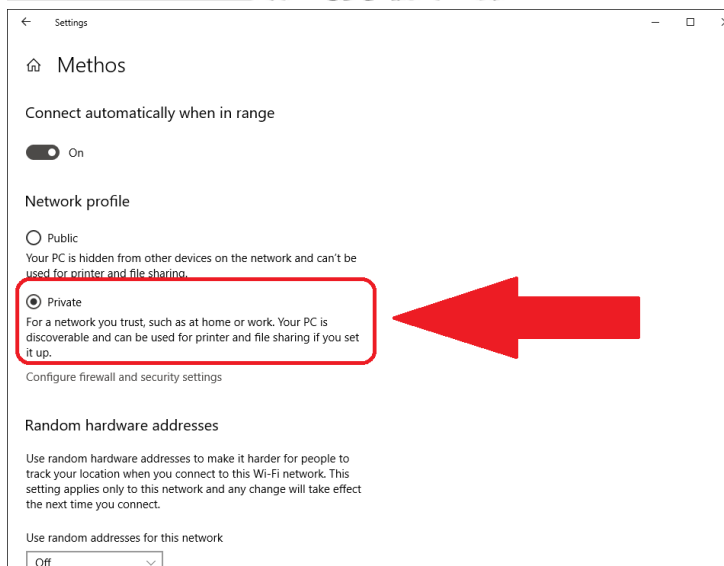
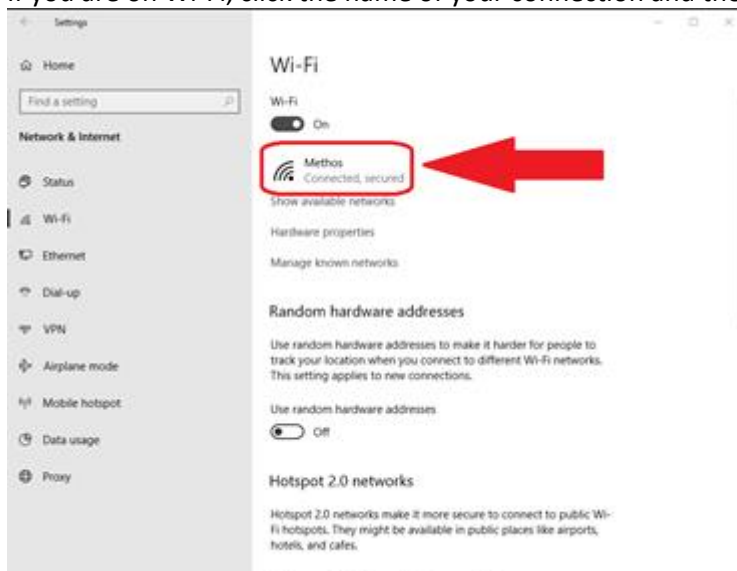

If you are Plugged in, choose Ethernet and then click Private

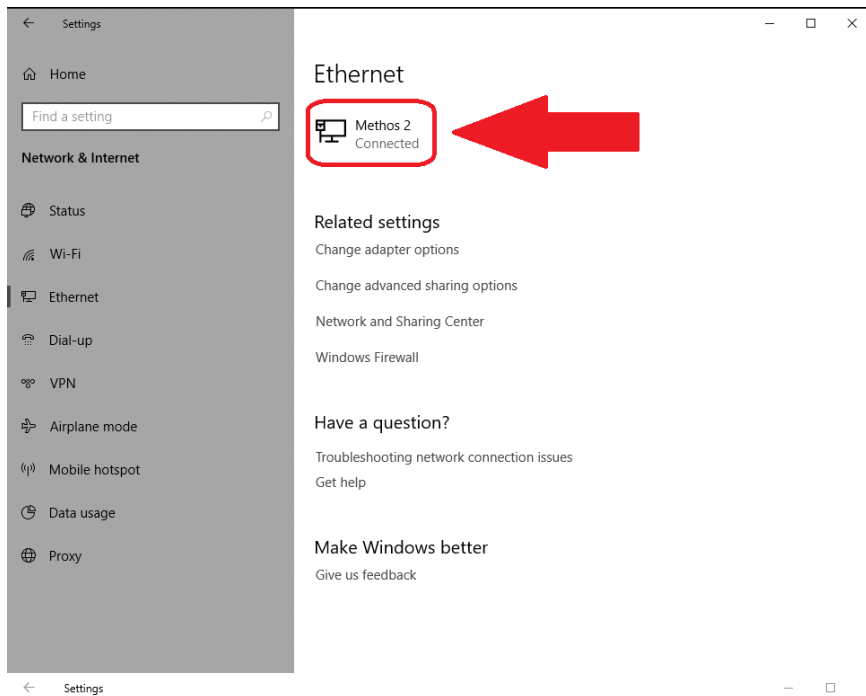

Methos 2

Network profile

☐ Public

Your PC is hidden from other devices on the network and can't be used for printer and file sharing.

☒ Private

For a network you trust, such as at home or work. Your PC is discoverable and can be used for printer and file sharing if you set it up.

[Configure firewall and security settings](#)

Metered connection

If you have a limited data plan and want more control over data usage, make this connection a metered network. Some apps might work differently to reduce data usage when you're connected to this network.

Set as metered connection

☐ Off

If you set a data limit, Windows will set the metered connection setting for you to help you stay under your limit.

[Set a data limit to help control data usage on this network](#)

6. You are now on a private network and can close the windows.

